

# CYLINDERS (Slope Pendant Mount) INSTALLATION INSTRUCTIONS

CAUTION: BEFORE CONNECTING THE FIXTURE TO A POWER SUPPLY, MAKE SURE THE POWER IS SWITCHED OFF.

## Wiring Identification

Fixture Power { White - Neutral  
Black - Hot/Line  
Green - Ground

0-10V Dimming { Purple - +0-10V  
Gray - -0-10V



t 800.900.1730 f 630.889.8106  
3609 Swenson Ave. St. Charles, IL 60174

### GENERAL:

1. Fixture must be installed by licensed electrician.
2. All electrical connections must be in accordance with local codes, ordinances, or the National Electrical Code.
3. Before starting the installation, make sure all electricity has been turned off and electrical breaker has been locked out and tagged out.
4. To ensure the success of the installation, be sure to read these instructions and review the diagrams thoroughly before beginning.

**NOTE:** The important safeguards and instructions appearing in this manual are not meant to cover all possible conditions and situations that may occur.

### INSTALLATION INSTRUCTIONS:

**NOTE:** Pendants with a standard 18" Stem come preassembled. These fixtures are intended to be mounted to a standard sized metal J-box. The box must be directly supported by the building structure.

- 1) Disconnect all power sources before attempting to install.
- 2) Mount Mono Point Crossbar as shown to 4" octagonal box. Align MP Crossbar Round with Downward Slope. Tip: If you back off screws on crossbar, then MP Plate will slide closer to J-Box. Remember to tighten crossbar screws when MP Plate, J-Box and MP Crossbar Round are in place.
- 3) Assemble stem into fixture and locknuts and pull wiring conductors out 6" longer than stem.
- 4) Insert canopy over stem.
- 5) Place MP Plate onto stem and thread half ball into stem.
- 6) Insert plastic snap Hole Busing into MP Swivel Clip and slide onto MP Plate HB.
- 7) Hinge MP Plate as shown above on inside of MP Crossbar. Slide the plate in so the tapped screw holes on the other side of the plate align with the crossbar. Fasten in place with 8/32" screw. Align plate with Downward Slope.
- 8) Push canopy to junction box and fasten to crossbar using 2-6/32" screws.
- 9) Restore power to circuit then test fixture.

**NOTE:** LED lamping is integral and NOT intended for general servicing.

### DETAILED ILLUSTRATION

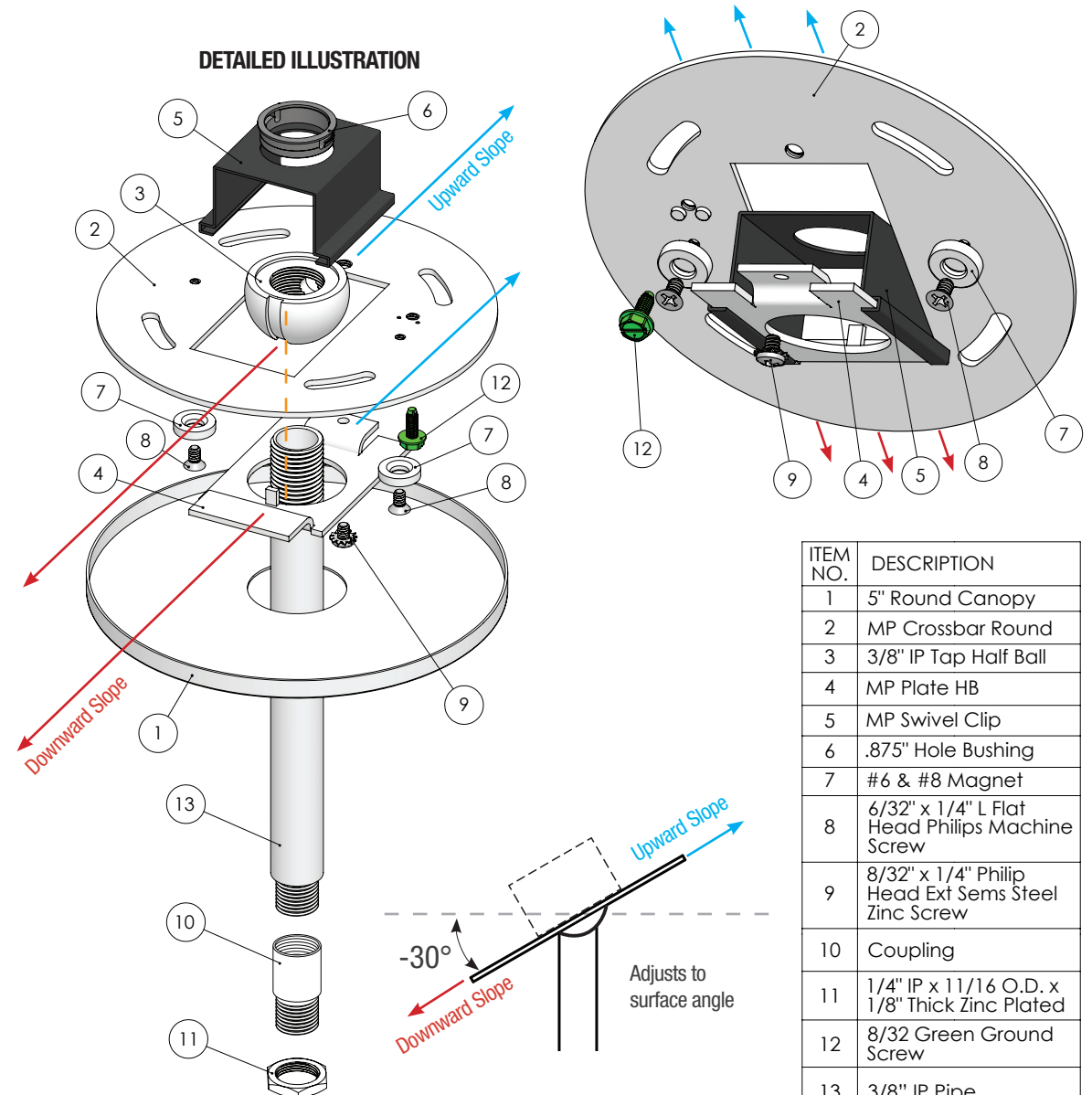

ITEM NO.	DESCRIPTION
1	5" Round Canopy
2	MP Crossbar Round
3	3/8" IP Tap Half Ball
4	MP Plate HB
5	MP Swivel Clip
6	.875" Hole Bushing
7	#6 & #8 Magnet
8	6/32" x 1/4" L Flat Head Philips Machine Screw
9	8/32" x 1/4" Philip Head Ext Sems Steel Zinc Screw
10	Coupling
11	1/4" IP x 11/16 O.D. x 1/8" Thick Zinc Plated
12	8/32 Green Ground Screw
13	3/8" IP Pipe